

BP-R Series Pulley (Fixed Shaft)

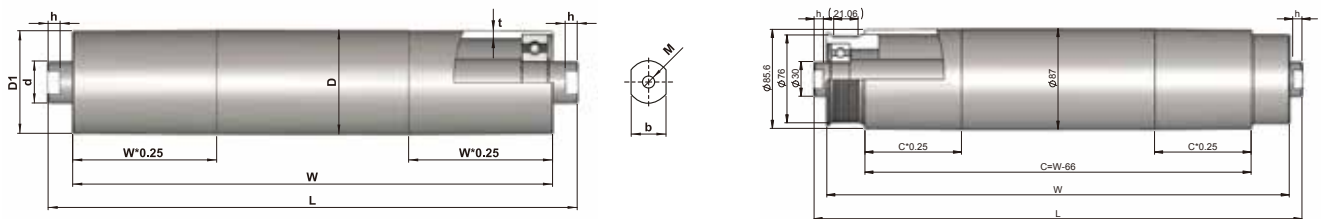

- Configured with precision bearings
- Precision machining, smooth rotation
- High load capacity, reliable and durable.

Dimensions(Steel Z/P)



Usually used for climbing belt conveyor

Specifications

Series	Standard				Drum (D1)	Length	Remarks
	Tube dia. (D)	Tube (t)	shaft dia. (d)	Bearing type		W	
05D	Φ51	(3.0)	Φ20	6204	/	450~1300	
06C	Φ59	(4.5)	Φ25	6205	Φ58	70~1300	
07C	Φ70	(6.5)	Φ30	6206	Φ69	70~1300	
08K	Φ75	(4.5)	Φ25	6005	Φ74	70~1300	
			Φ40	6008			
08C	Φ79	(4.5)	Φ25	6005	Φ77.6	70~1300	
			Φ30	6306			
08J	Φ87	(4.5)	Φ25	6205	Φ85.6	70~1300	
			Φ35	6307			
10B	Φ100	(6.0)	Φ30	6306	Φ98	70~1800	
			Φ40	6308			
11D	Φ112	(6.0)	Φ30	6306	Φ110	70~1800	
			Φ35	6307			
12A	Φ119	(6.0)	Φ30	6306	Φ117	70~1800	
			Φ40	6408			
08J	Φ87	(4.5)	Φ30	6206	Φ85.6	180~1300	Steel Poly-vee

⚙ Straight tube is available—not tapered ; “(t)” is not accurate data.
If there is dynamic balance requirement for products, please contact us.