

BP-D Series Pulley (Rotating Shaft)

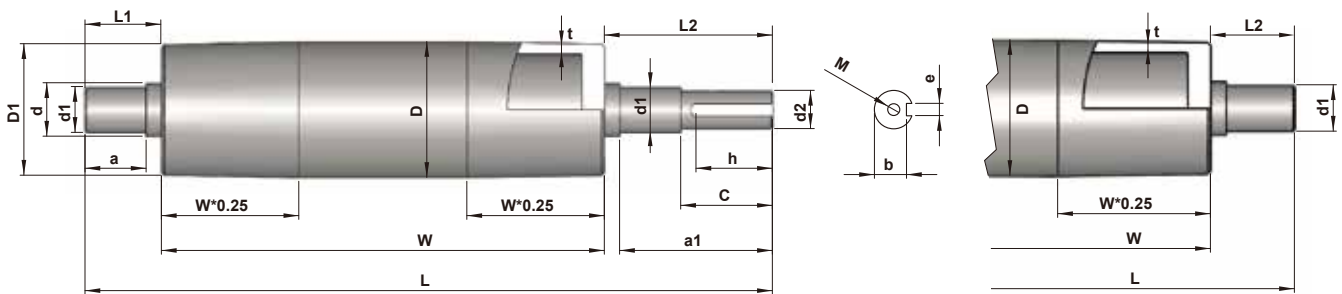

- Thermal refining shaft
- Special welding equipment and technology
- New structure, strong and reliable

Dimensions(Steel Z/P)



Specifications

Series	Standard				Optional	Length		
	Tube dia. (D)	Tube (t)	shaft dia. (d1)	Drum (D1)	Optional shaft dia.(d1)	W	L	L1/L2
06C	Φ59	(4.5)	Φ25	Φ58	Φ20	250~1300	≤1500	≤280
08K	Φ75	(4.5)	Φ30	Φ74	Φ25	250~1300	≤1500	≤280
					Φ35			≤185
08J	Φ87	(4.5)	Φ30	Φ85.6	Φ25	250~1300	≤1500	≤280
					Φ35			≤185
10B	Φ100	(6.0)	Φ30	Φ98	Φ25	250~1400	≤1600	≤280
					Φ35			≤185
11D	Φ112	(6.0)	Φ35	Φ110	Φ30	250~1400	≤1600	≤280
					Φ40			≤185, When ≥ Φ40, ≤140
12A	Φ119	(6.0)	Φ35	Φ117	Φ40	250~1400	≤1600	≤185, When ≥ Φ40, ≤140
13C	Φ130	(6.5)	Φ35	Φ127	Φ40	70~1800	≤2400	≤300
14K	Φ137	(6.5)	Φ35	Φ135	Φ40	70~1800	≤2400	≤300
15J	Φ156	(6.5)	Φ35	Φ153	Φ40	70~1800	≤2400	≤300
18K	Φ176	(6.0)	Φ40	Φ173	Φ45	70~1800	≤2400	≤300
20C	Φ200	(6.5)	Φ45	Φ196	Φ50/55	70~1800	≤2400	≤300
21J	Φ216	(8.5)	Φ50	Φ212	Φ55	70~1800	≤2400	≤300

⚙ Straight tube is available—not tapered ; “(t)” is not accurate data.
If there is dynamic balance requirement for products, please contact us.

Dimensions(Surface Coating Type)

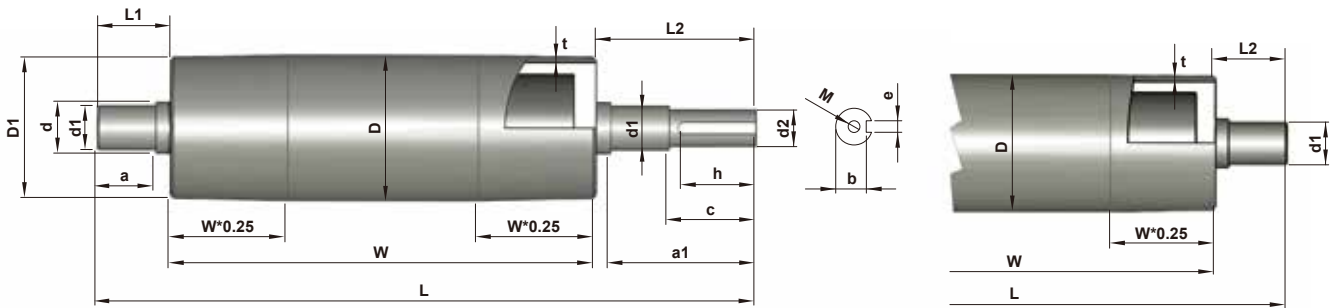

Specifications

Series	Standard configuration				Optional	Length		
	After coating (D)	Surface Polyurethane (t)	shaft dia. (d1)	Drum (D1)	Optional shaft dia.(d1)	W	L	L1/L2
08J	Φ87	(6.0)	Φ30	Φ85.6	Φ25	250~1400	≤1600	≤280
					Φ35			≤185
10B	Φ100	(6.0)	Φ30	Φ98	Φ25	250~1400	≤1600	≤280
					Φ35			≤185
11D	Φ112	(6.0)	Φ35	Φ110	Φ30	250~1400	≤1600	≤280
					Φ40			≤185, When ≥ Φ40, ≤140
12A	Φ122	(5.0)	Φ35	Φ120	Φ40	250~1400	≤1600	≤185, When ≥ Φ40, ≤140
13C	Φ130	(5.5)	Φ35	Φ127	Φ40	250~1400	≤1600	≤185, When ≥ Φ40, ≤140
15J	Φ156	(6.0)	Φ35	Φ153	Φ40	70~1800	≤2400	≤300
18K	Φ176	(5.0)	Φ40	Φ173	Φ45	70~1800	≤2400	≤300
20C	Φ202	(5.0)	Φ45	Φ199	Φ50/55	70~1800	≤2400	≤300
21J	Φ216	(7.5)	Φ50	Φ212	Φ55	70~1800	≤2400	≤300

⚙ Straight tube is available—not tapered ; “(t)” is not accurate data.
 Coating material : Polyurethane (yellow)
 (If the pulley length is out of above, please contact us.)

